

CARACTERÍSTICAS DA ONDULAÇÃO TRANSVERSAL (LOMBADA)

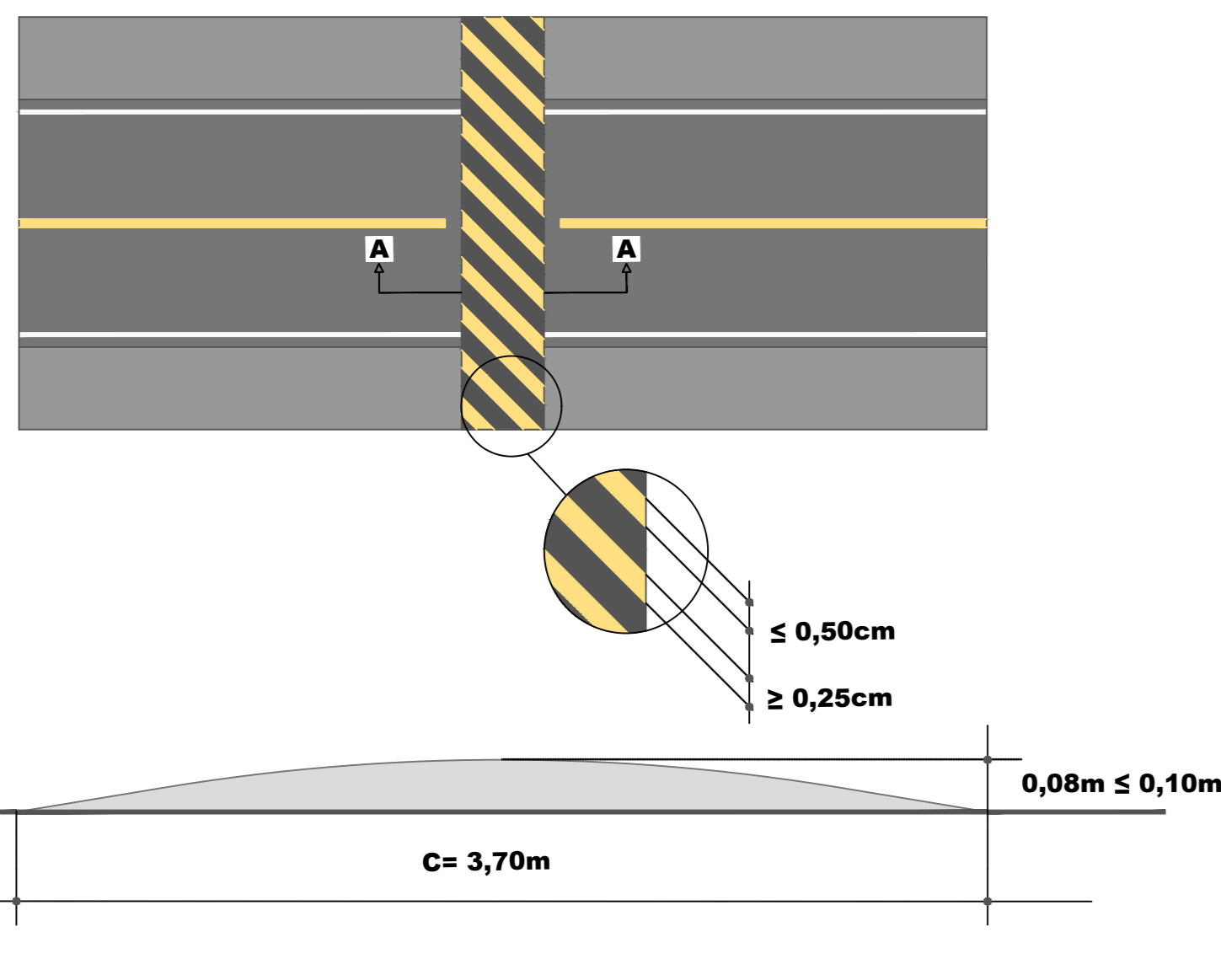

DETALHE FAIXA ELEVADA VISTA EM PLANTA S/ ESCALA

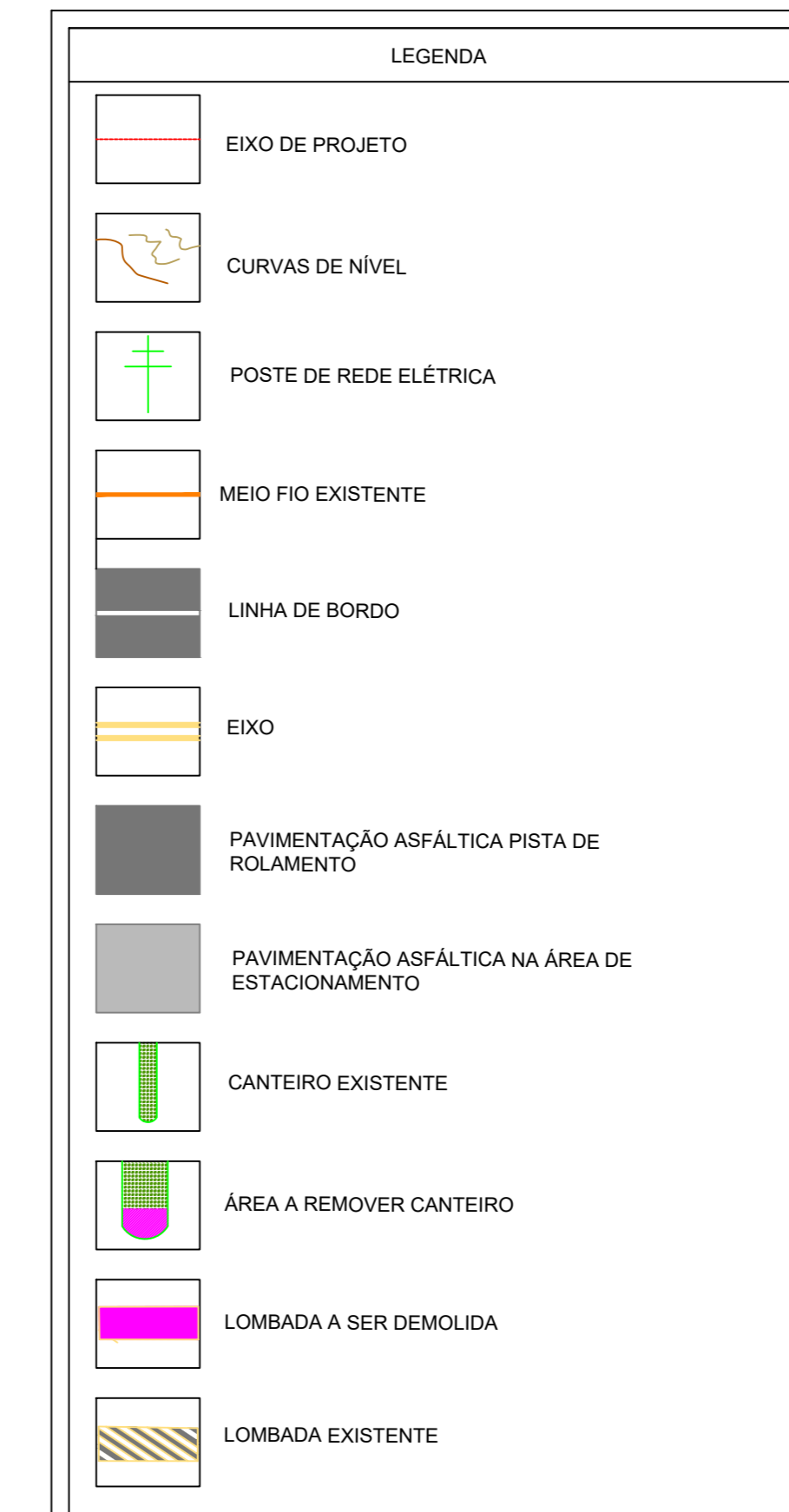
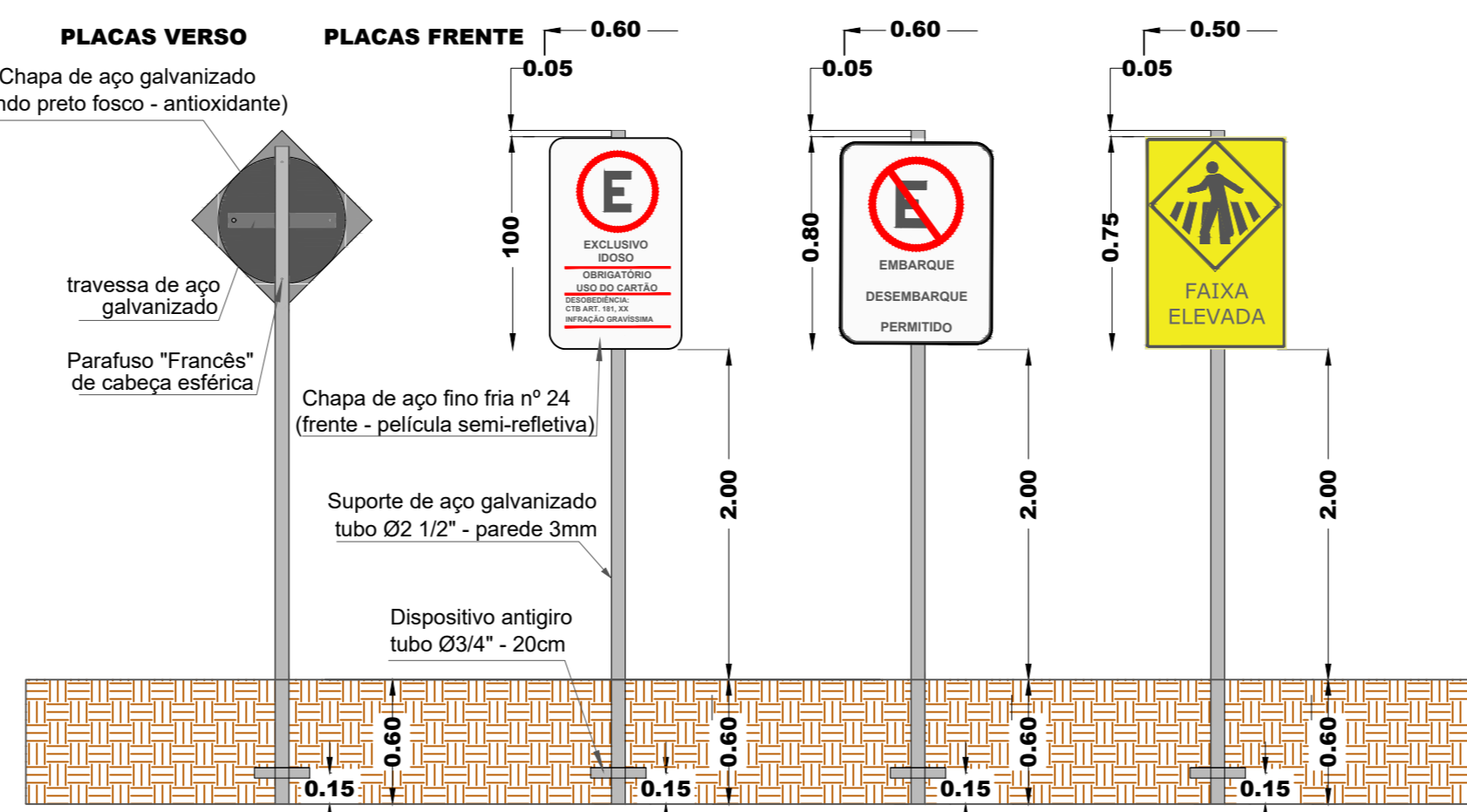
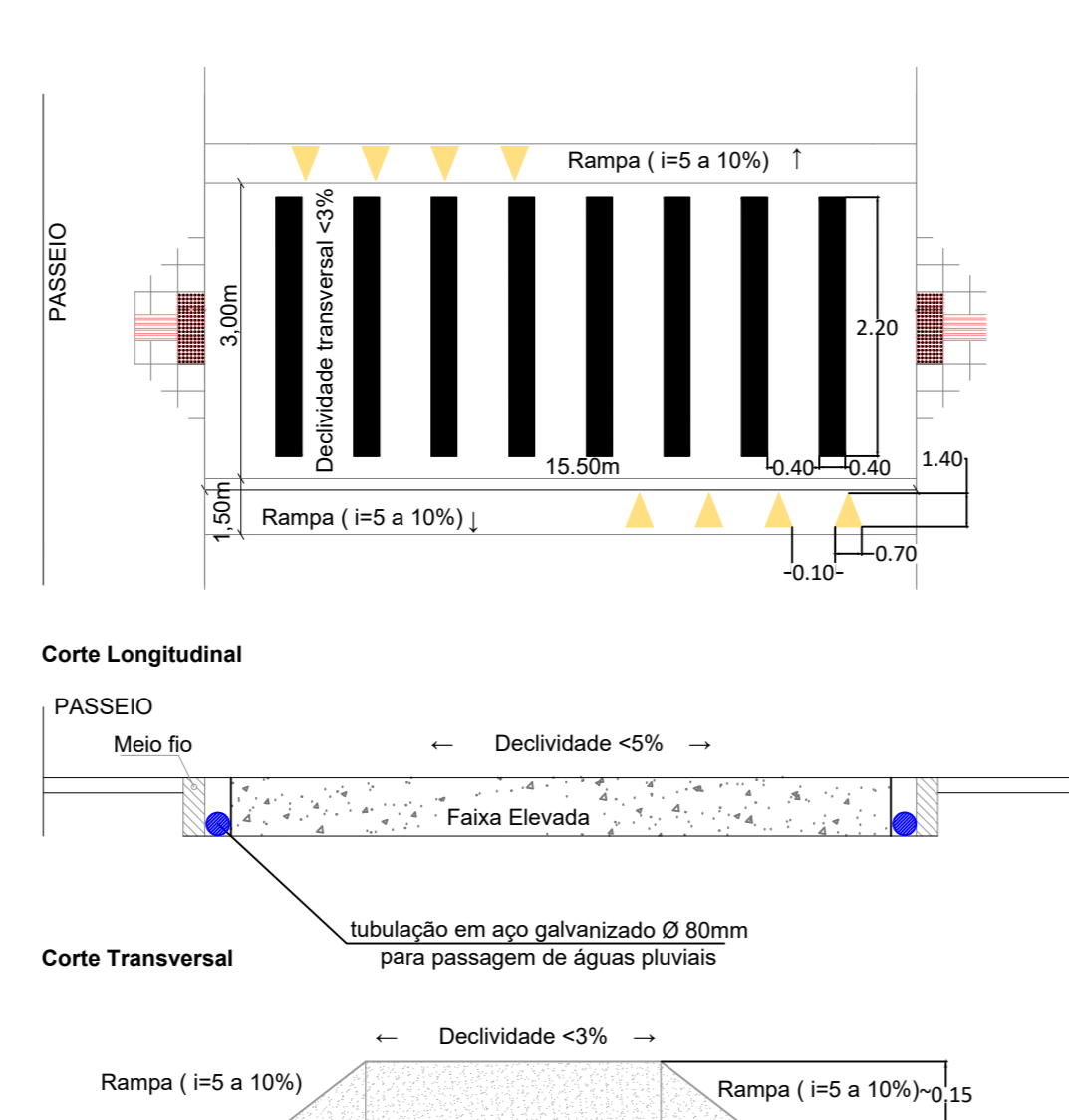

PROJETO DE REPERFILAGEM ASFÁLTICA

RUA: PREF. OCT. URB. SIMON, RUA PRAÇA RIO BRANCO E R. PREF. REBELATO

MUNICÍPIO(S): XAVANTINA

ESTADO UF: SC

DATA: 09/2022

ESCALA: 1:750

Prop.: PREFEITURA MUNICIPAL DE XAVANTINA

Resp. Téc.: CARLOS ALEXANDRE ROMANI ENGENHEIRO AGRIMENSOR CREA-SC 172.521-8



XAVANTINA - SC GOVERNO MUNICIPAL

Rua Prefeito Octávio Urbano Simon, Nº 163, Centro

CEP: 89760-000. Fone: (49) 3454-3100

www.xavantina.sc.gov.br